



# 邦皇凡而工業股份有限公司

PANG HUANG VALVE INDUSTRIAL CO., LTD.

## 邦皇凡而工業股份有限公司

PANG HUANG VALVE INDUSTRIAL CO., LTD.

- 觀測器
- 球塞凡而
- 蝶型凡而
- 鑄鐵、鑄鋼WCB
- 無聲逆止閥304#
- 不銹鋼鑄件304#，316#
- 各式凡而製造



### VALVE



榮獲國際標準品質 ISO 9001、CE0035 認證

地址：新北市蘆洲區復興路30號之5

電話：(02)2282-7532

(02)2283-4196

(02)2283-4198

傳真：(02)2283-4197

信箱：skcfv@ms43.hinet.net

網站：www.panghuang-valve.com.tw



邦皇凡而工業

# Certificate

## Quality-Assurance System

acc. to Directive 2014/68/EU

Certificate no.: 01 202 TWN/Q-06 0141

Name and address of the manufacturer: **Pang Huang Valve Industrial Co., Ltd.  
No. 30-5, Fuxing Road, Luchou District,  
New Taipei City 24744, Taiwan, R.O.C.**

Herewith we certify that the above -mentioned manufacturer operates a quality system according to the European Directive 2014/68/EU. The manufacturer has the permission to affix the following CE marking to pressure equipment described and manufactured in accordance to the scope covered by this Quality-Assurance System:

**CE 0035**

Tested acc. to Directive 2014/68/EU: **QS-System (Module D1)**  
(the QS-Modules E1 and E are covered by Module D1)

Audit report no.: TWN/Q-06 0141

Area of validity: Manufacturing of Industrial Valves and Sight Flow Indicator, see annex to certificate

Manufacturing plant: Pang Huang Valve Industrial Co., Ltd.  
No. 30-5, Fuxing Road, Luchou District,  
New Taipei City 24744, Taiwan, R.O.C.

Valid until: October 30, 2021



Cologne, October 19, 2018 i.V. Dipl.-Ing. Oliver Theisen

TÜV Rheinland Industrie Service GmbH  
Notified Body for Pressure Equipment, ID-No. 0035  
Am Grauen Stein, D-51105 Köln

E-008-E-Rev22

## *Certificate of Registration*

*This is to certify that the*

### **QUALITY MANAGEMENT SYSTEM**

*of*

### **Pang Huang Valve Industrial Co., Ltd.**

**No. 30 - 5, Fuxing Road, Luchou District, New Taipei City, 24744, TAIWAN, R.O.C.**

*for*

**Manufacture of Valves (Ball Valves, Butterfly Valves, Gate Valves, Flap Valves  
and Sight Glass)**

*has been assessed and registered against the provisions of*

### **ISO 9001:2015**

*International Standard*

*with*

Registration Number: 024240  
Certification Date: 28 August 2018  
Recertification Due Date: 14 August 2021

Project: 12-02049-6-Q  
Code: DK 29.13

Certification Approved By:



Mahmut Sogukpinar

Chief Operating Officer



Registration is subject to the management system being continually maintained to the above standard under regular surveillance. Should surveillance not take place when required, registration shall be removed.

This certificate is the property of Globalgroup of Companies Limited,  
21 Lansdowne Crescent, Edinburgh, Midothian, EH12 5EH, Scotland, United Kingdom.

Please validate the authenticity of the certificate at [www.globalgroup.net](http://www.globalgroup.net)



80003830



1 **TYPE EXAMINATION CERTIFICATE**

2 Equipment intended for use in Potentially Explosive Atmospheres Directive 94/9/EC

3 Certificate Number: **Sira 10ATEX6378X** Issue: **0**

4 Equipment: **Sight Glass Fittings Models SK-T6, SK-T9, SK-B2-PN16 and SK-B2-150**

5 Applicant: **Pang Huang Valve Industrial Co Ltd**

6 Address: No 30-5 Fuxing Road  
Luzhou District  
New Taipei City  
24744  
Taiwan  
Republic of China

7 This equipment and any acceptable variation thereto are specified in the schedule to this certificate and the documents therein referred to.

8 Sira Certification Service certifies that this equipment has been found to comply with the Essential Health and Safety Requirements that relate to the design of Category 2 equipment, which is intended for use in potentially explosive atmospheres. These Essential Health and Safety Requirements are given in Annex II to European Union Directive 94/9/EC of 23 March 1994.

The examination and test results are recorded in the confidential reports listed in Section 14.2.

9 Compliance with the Essential Health and Safety Requirements, with the exception of those listed in the schedule of this certificate, has been assessed by reference to:

EN 13463-1:2009

10 If the sign "X" is placed after the certificate number, it indicates that the equipment is subject to special conditions for safe use specified in the schedule to this certificate.

11 This TYPE EXAMINATION CERTIFICATE relates only to the design of the specified equipment, and not to specific items of equipment subsequently manufactured.

12 The marking of the equipment shall include the following:

 II 2 G D TX  
Ta = -20°C to +60°C

Project Number 22889

This certificate and its schedules may only be reproduced in its entirety and without change.

  
C Ellaby  
Deputy Certification Manager

**Sira Certification Service**

Rake Lane, Eccleston, Chester, CH4 9JN, England

Tel: +44 (0) 1244 670900  
Fax: +44 (0) 1244 681330  
Email: [info@siracertification.com](mailto:info@siracertification.com)  
Web: [www.siracertification.com](http://www.siracertification.com)



# STAINLESS STEEL 2 PEC BALL VALVE



**MODEL : SK.3 STAINLESS STEEL304,  
316 ANSI150LB, JIS10K**



**150 PSI WOG NON-SOCK**

PART NAME	MATERIAL
BODY	304, 316
END CAP	304, 316
BALL	304, 316
STEM	304, 316
SEAL / SEAT	TEFLON
GLAND	304
GASKET	TEFLON
HANDLE	FCD 45
BOLT	304

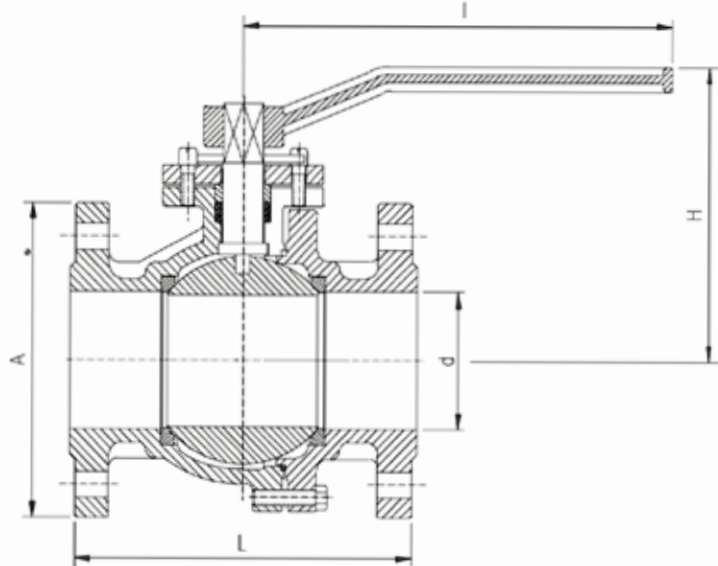

**TESE PRESSURE :**  
**BODY 230PSI (WATER)**  
**SEAT 100PSI (AIR)**

## DIMENSIONS

SIZE	IN	1/2	3/4	1	1 <sup>1</sup> / <sub>4</sub>	1 <sup>1</sup> / <sub>2</sub>	2	2 <sup>1</sup> / <sub>2</sub>	3	4	5	6	8	10
	mm	15	20	25	32	40	50	65	80	100	125	150	200	250
BORE SIZE d		15	21.6	25	32	38	50	65	78	98	124	149	198	250
L END TO END		110	120	130	140	165	180	190	203	230	300	394	457	533
H HEIGHT		82	90	90	113	113	120	152	170	184	200	245	276	325
I HANDLE		145	145	145	145	230	230	406	400	445	445	595	595	595
FLANGED END	ACC. TO JIS 10K OR ANSI 150LBS SPECIFICATION													



# STAINLESS STEEL 2 PEC BALL VALVE



## MODEL : SK.2 FLANGED END FULL BORE



**150 PSI WOG NON-SOCK**

PART NAME	MATERIAL
BODY	304
END CAP	304
BALL	304
STEM	304
SEAL / SEAT	PTFE
GLAND	304
GASKET	PTFE
HANDLE	FCD
BOLT	304

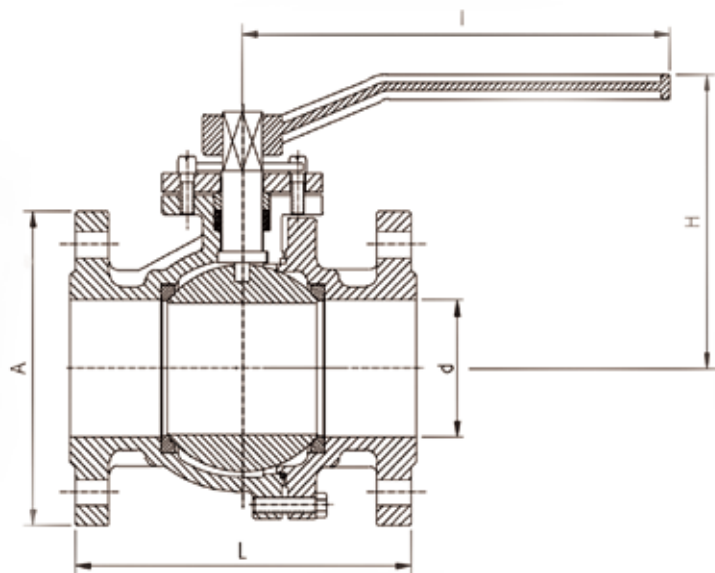

**TESE PRESSURE :**  
**BODY 230PSI (WATER)**  
**SEAT 100PSI (AIR)**

### DIMENSIONS

SIZE	IN	1/2	3/4	1	1 <sup>1</sup> / <sub>4</sub>	1 <sup>1</sup> / <sub>2</sub>	2	2 <sup>1</sup> / <sub>2</sub>	3	4	5	6	8	10
	mm	15	20	25	32	40	50	65	80	100	125	150	200	250
BORE SIZE d		15	20	25	32	38	50	65	78	98	124	149	198	250
L END TO END		110	120	130	140	165	180	190	203	230	300	394	457	533
H HEIGHT		88	93	100	100	125	135	148	155	190	235	250	270	325
I HANDLE		145	145	145	133	230	215	295	295	385	590	590	590	590
FLANGED END	ACC. TO JIS 10K OR ANSI 150LBS SPECIFICATION													



# CAST IRON 2 PEC BALL VALVE



**MODEL : SK.1 FLANGED END  
FULL BORE**

**150 PSI WOG NON-SOCK**

PART NAME	MATERIAL
BODY	FC-20
END CAP	FC-20
BALL	304
STEM	304
SEAL / SEAT	TEFLON
GLAND	FCD 45
GASKET	PTFE
HANDLE	FCD 45
BOLT	SS 41

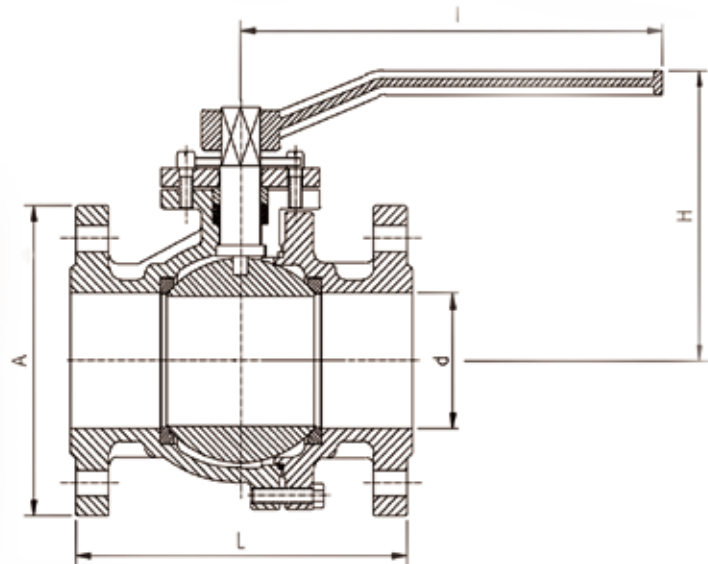

**TESE PRESSURE :**  
**BODY 230PSI (WATER)**  
**SEAT 100PSI (AIR)**

## DIMENSIONS

SIZE	IN	1/2	3/4	1	1 <sup>1</sup> / <sub>4</sub>	1 <sup>1</sup> / <sub>2</sub>	2	2 <sup>1</sup> / <sub>2</sub>	3	4	5	6	8	10
	mm	15	20	25	32	40	50	65	80	100	125	150	200	250
BORE SIZE d		15	20	25	32	38	50	65	78	98	124	149	198	250
L END TO END		110	120	130	140	165	180	190	203	230	300	340	450	540
H HEIGHT		82	90	90	100	113	120	152	170	184	200	245	276	325
I HANDLE		133	133	133	133	215	215	295	295	385	590	590	590	590
FLANGED END	ACC. TO JIS 10K OR ANSI 150LBS SPECIFICATION													



# AIR CYLINDER BALL VALVE



## MODEL : SK.6 AIR CYLINDER BALL VALVE

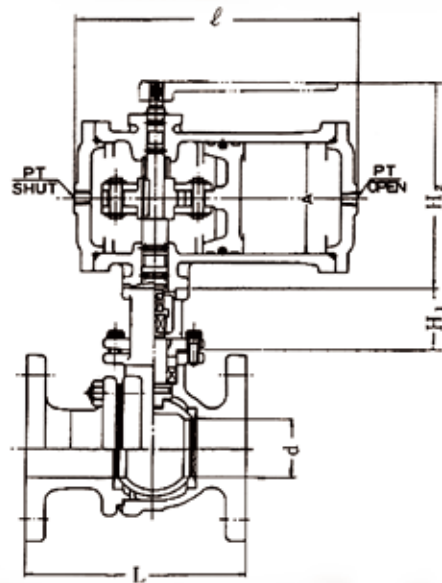

PART NAME	MATERIAL
BODY	CAST IRON 304, 316
BALL	STAINLESS STEEL
STEM	STAINLESS STEEL
SEAT RING	PTFE
AIR CYLINDER	CAST IRON

W.P	10 kg/cm <sup>2</sup>
W.T	180°C~200°C

**USAGE SCOPE :**  
WATER, STEAM, AIR, GAS, GENERAL,  
LIQUID

### DIMENSIONS

NOMI- SIZE	1/2B	3/4	1	1 1/2	2	2 1/2	3	4	5	6	8
		15A	20	25	40	50	65	80	100	125	150
d	15	20	25	40	50	65	80	100	125	150	200
L	110	120	130	165	180	190	203	230	300	340	450
H1	63	63	63	63	89	89	89	89	90	100	100
H2	115	115	115	124	149	175	175	211	235	270	290
ℓ	190	190	190	210	240	270	270	310	370	490	505
PT	1/4"	1/4"	1/4"	1/4"	1/4"	1/4"	1/4"	1/4"	1/4"	3/8"	3/8"





# CYLINDER BALL VALVE

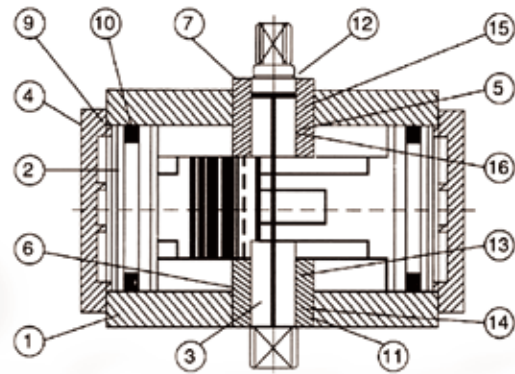
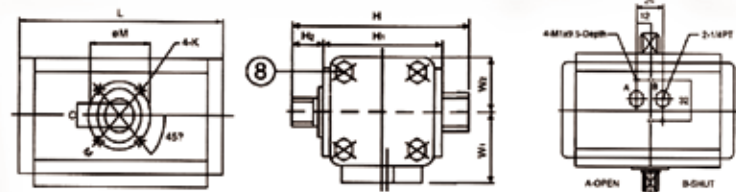

SIZE	L	H1	H2	H3	W1	W2	M
36	93	54	11				36
50	132	70	20	105	40	30	50
63	162	88.5	21	125	48	38	50
80	191	106.5	21	151	56	46	70
100	236	130	25	184	68	58	70
130	260	170	26	221	85	73	102
160							102

SIZE	OUT/IN	4 kg/cm	5 kg/cm	6 kg/cm	7 kg/cm
36	OUT	11.1	13.9	18.6	19.6
	IN	10.4	13.0	15.6	10.2
50	OUT	33	41.5	50	58
	IN	26	35.2	42	49.2
63	OUT	62.8	78.4	94	109
	IN	56	70.4	84	98
80	OUT	126	157	189	221
	IN	108	135	162	190
100	OUT	238	295	755	414
	IN	215	269	323	377
130					
160					

NO.	DESCRIPTION	MATERIAL
1	HOUSING BODY	ALUMINIUM ALLOY 6001
2	PISTON WITH RACK	ZINC ALLOY TBAC 3
3	SPINDLE	MILD STEEL AISI 1045
4	BODY AND CAP	ALUMINIUM ALLOY TBAC 10
5	UPPER SPINDLE BUSHING	ACETAL PLASTICS
6	LOWER SPINDLE BUSHING	ACETAL PLASTICS
7	PISNDLE SPINDLE BUSHING	ACETAL PLASTICS
8	FIRING SCREW	STAINLESS STEEL SS304
9	GASKET FOR END CAP	NBR RUBBER
10	O-RING OF PISTON	NBR RUBBER
11	R-CLIP FOR SPINDLE	SPRING STEEL
12	C-CLIP	SPRING STEEL
13	O-RING FOR LOWER SPINDLE BUSHING	NBR RUBBER
14	O-RING FOR LOWER SPINDLE BUSHING	NBR RUBBER
15	O-RING FOR UPPER SPINDLE BUSHING	NBR RUBBER
16	O-RING FOR UPPER SPINDLE BUSHING	NBR RUBBER



# CYLINDER BALL VALVE

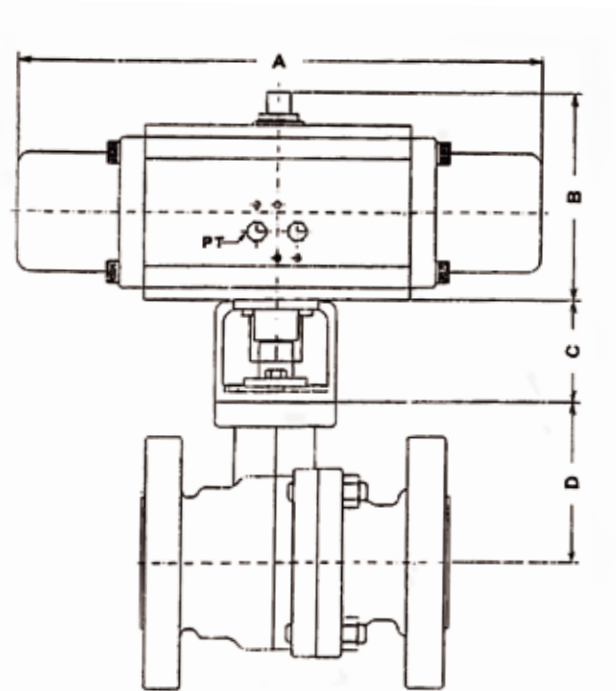

NO.	名稱	材質
1	心桿	中碳鋼S45C
2	本體	鋁合金6061
3	側蓋	鋁合金AC12
4	連接架	SUS 304
5	接頭	SUS 304
6	閥本體	—

## DIMENSIONS

SIZE	IN	50	63	80	100	130	130加長
A		190	238	300	402	438	508
B		90	111	127	158	197	197
C		58	66	90	90	90	100
D		—	—	—	—	—	—
PT		1/4"	1/4"	1/4"	1/4"	1/4"	1/4"



# STAINLESS STEEL BALL VALVE



**MODEL : SK.5 CAST IRON, CAST  
STEEL, STAINLESS STEEL  
WORM GEAR OPERATOR**

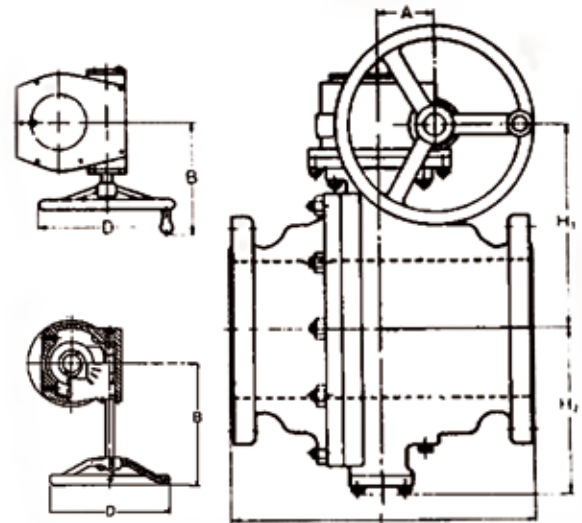

PART NAME	MATERIAL
BODY	CAST STEEL & STAINLESS STEEL
BALL	STAINLESS STEEL
STEM	STAINLESS STEEL
SEAT RING	TEFLON
WORM	CARBON STEEL
WORM GEAR	DUCTILE IRON
HANDLE	CAST IRON
BOLT AND NUT	STEEL & STAINLESS STEEL

**USAGE SCOPE :**  
**WATER, STEAM, AIR, GAS, GENERAL, LIQUID**

### DIMENSIONS

SIZE NOMINAL	8" 200A	10" 250	12" 300	14" 350	16" 400	FLANGE LB.KG / CM <sup>2</sup>
<b>d</b>		250	305	337		150LB,10K
<b>L</b>		533	610	686		150LB,10K
<b>H1</b>		237	468*568	508*608		150LB,10K
<b>H2</b>		335	379	419		150LB,10K
<b>D</b>		200	460	460		150LB,10K
<b>A</b>		62.5	108	108		150LB,10K
<b>B</b>		251	320	320		150LB,10K

REMARK : H1 \*DIMENSION OF STAINLESS STEEL

<b>W.P</b>	10 kg/cm <sup>2</sup>
<b>W.T</b>	180°C~200°C

**FACE TO FACE :**

**ANSI B16.10 (API 6D)**

**FLANGE CAST STEEL.10K :**

**JIS B2214 (RF)**

**150LB : ANSI B16.5**

**STAINLESS STEEL.10K :**

**JIS B2212 (RF)**

**150LB : ANSI B16.5**



# STAINLESS CYLINDER BALL VALVE

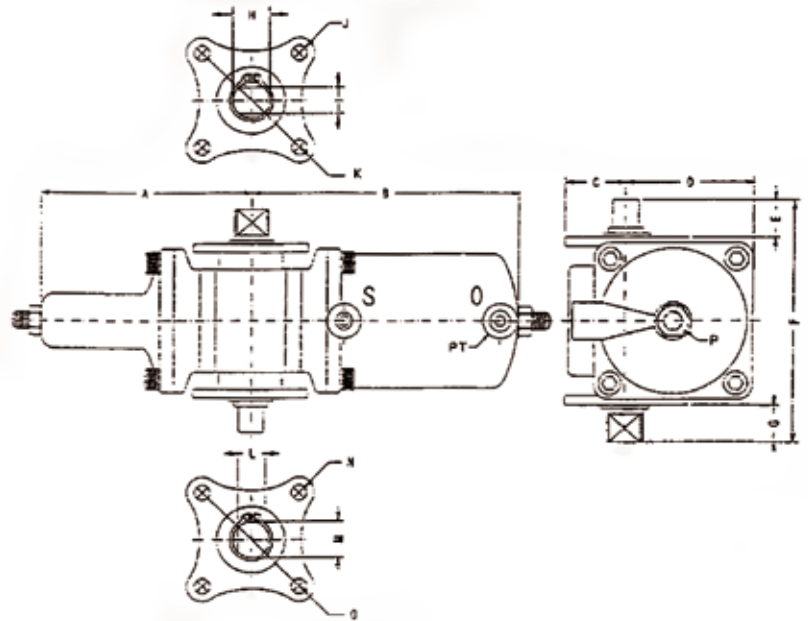

## DIMENSIONS

	A	B	C	D	E	F	G	H	I	J	K	L	M	N	O	P	PT
50	95	107	26	51	20	110	20	15	10	M6	50	10	15	M6	50	M8	1/4"
70	120	135	33	68	20	134	20	19	14	M8	70	14	19	M8	70	M10	1/4"
90	127	160	36	78	25	163	30	18	14	M8	70	18	25	M8	70	M10	1/4"
110	149	175	43	94	30	192	30	18	14	M8	70	18	25	M8	70	M10	1/4"
130	183	210	51	108	30	211	30	25	18	M8	70	18	25	M8 / M10	70 / 102	M12	1/4"
160	205	238	57	127	30	242	30	30	23	M8	70	23	30	M10 / M12	102 / 125	M12	1/4"



# DIN BALL VALVE



MODEL : DIN PN16~PN40

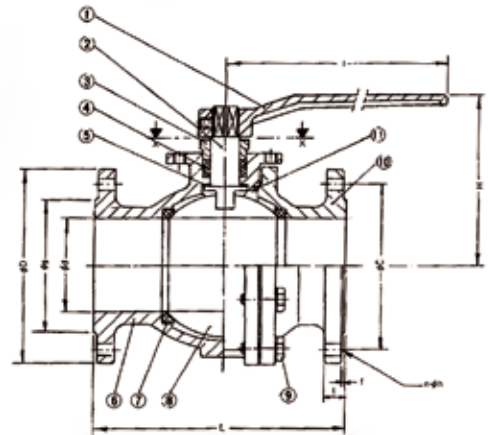
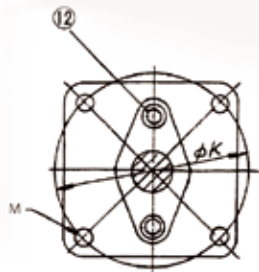

ITEM	PART NAME	MATERIAL	ITEM	PART NAME	MATERIAL
1	HANDLE	CAST STEEL	7	BALL SEATS	PTFE
2	STEM	S.S316 S.S304	8	BALL	S.S316 S.S304
3	GLAND	CAST STEEL	9	BOLTS	STEEL
4	STEM PAKING	GLAPHIT / PTFE	10	CAP	CAST STEEL GS-C25
5	THRUST WASHER	PTFE	11	GASKET	GLAPHIT / PTFE
6	BODY	CAST STEEL S304 / S316	12	BOLTS	STEEL

## DIMENSIONS

DIN PN16

SIZE DN	15	20	25	32	40	50	65	80	100	125	150	200	250	300
D	95	105	115	140	150	165	185	200	220	250	285	340		
g	45	58	68	78	88	102	122	138	158	188	212	268		
d	15	20	25	32	40	50	65	80	100	125	150	200	250	300
c	65	75	85	100	110	125	145	160	180	210	240	295		
t	14	16	16	16	16	18	18	20	20	22	22	24		
f	2	2	2	2	3	3	3	3	3	3	3	3		
n	4	4	4	4	4	4	4	4	4	8	8	12		
h	14	14	14	18	18	18	18	18	18	18	23	23		
L	115	120	125	130	140	150	170	180	190	325	350	400		
K	50	50	70	70	70	102	102	102	102	102	102	102	125	140
M	M6	M6	M8	M8	M8	M8	M10	M10	M10	M10	M10	M10	M12	M16



# SCREW 2 PEC BALL VALVE

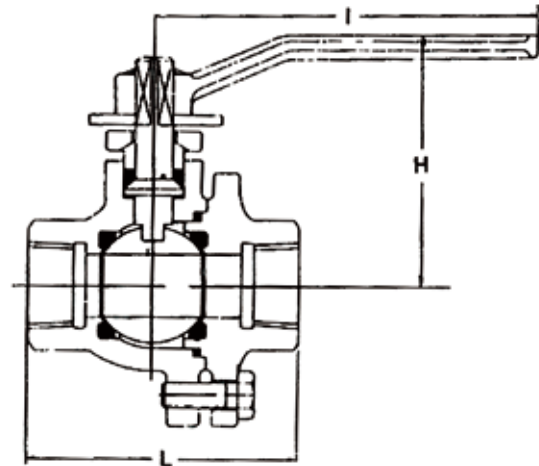

PART NAME	MATERIAL
BODY	S.S. 304
END CAP	S.S. 304
BALL	304
STEM	SUS 304
SEAL / SEAT	PTFE
GLAND	WCB
GASKET	PTFE
HANDLE	FCD
BOLT	SS 41

**TESE PRESSURE :**  
**BODY 230PSI (WATER)**  
**SEAT 100PSI (AIR)**

**W. PRESSURE : 150PSI WOG NON-SHOCK**

## DIMENSIONS

SIZE	IN	1/2	3/4	1	1 <sup>1</sup> / <sub>4</sub>	1 <sup>1</sup> / <sub>2</sub>	2	2 <sup>1</sup> / <sub>2</sub>	3	4
	mm	15	20	25	32	40	50	65	80	100
BORE SIZE		15	21.6	24.5	32	38	50	62	74	98
<i>L</i> END TO END		77	80	90	100	118	141	160	182	245
<i>H</i> HEIGHT		77	80	95	105	125	145	151	170	196
<i>I</i> HANDLE		133	133	133	133	215	215	295	295	385



# 2 PEC BALL VALVE



ITEM	DESCRIPTION	STAINLESS STEEL	CARBON STEEL
1	BODY	CF8M	WCB
2	BODY CAP	CF8M	WCB
3	SEAT	R-PTFE	R-PTFE
4	JOINT GASKET	PTFE	PTFE
5	BALL	CF8M	AISI 304
6	THRUST WASHER	R-PTFE	R-PTFE
7	STME PACKING	PTFE	PTFE
8	GLAND NUT	AISI 304	AISI 304
9	STME	AISI 316	AISI 304
10	SPRING WASHER	AISI 304	AISI 304
11	STME NUT	AISI 304	AISI 304
12	HANDLE	AISI 304	C/S ZINC PLATED
13	STOP SCREW	AISI 304	AISI 304
14	STOP NUT	AISI 304	AISI 304
15	PLASTIC COVER	PVC	PVC

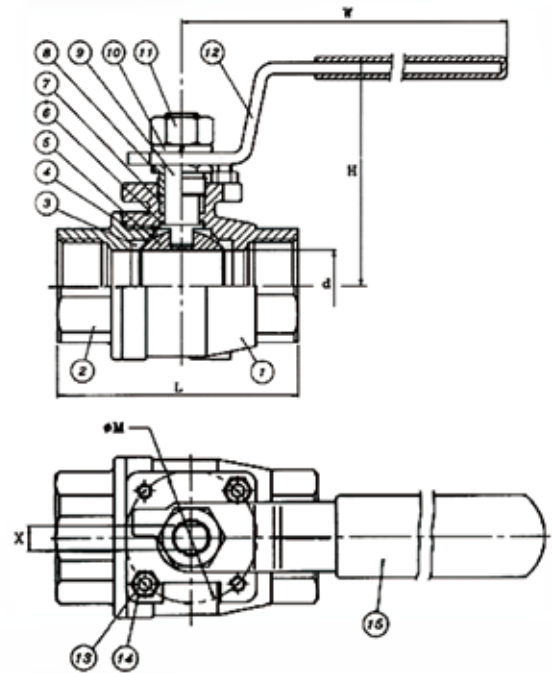

INCH	mm	d	L	H	W	X	M	K	Z	Wt(KGS)	TORQUE(kgf-m)
1/4	11	11.5	58	60	100	5	36	11	8	0.38	35
3/8	12	12.7	58	60	100	5	36	11	8	0.32	35
1/2	15	15	60.5	62	100	5	36	11	8	0.38	38
3/4	20	20	72	68	105	6	36	16	10	0.52	55
1	25	25.4	85	80	155	8	42	16	12	0.92	80
1 1/4	32	32	97	86	155	8	42	16	12	1.40	130
1 1/2	38	38	116	86	178	8	50	18	14	2.06	170
2	50	50	133	95	178	8	50	18	14	3.45	210
2 1/2	65	65	166	132	265	12	70	29	19	5.90	405
3	80	80	189	143	265	12	70	29	19	12.5	1250



# 3 PEC BALL VALVE



NO.	DESCRIPTION	MATERIAL
1	BODY	ASTM A351-CF8M
2	CAP	ASTM A351-CF8M
3	BALL	ASTM A351-CF8M
4	STEM	ASTM A276-316
5	GLAND NUT	AISI 304
6	BALL SEAT	*R-PTFE
7	BODY SEAT	PTFE
8	PACKING	PTFE
9	THRUST WASHER	PTFE
10	SPRING WASHER	AISI 304
11	STEM NUT	AISI 304
12	BOLT	AISI 304
13	BOLT NUT	AISI 304
14	SPRING WASHER	AISI 304
15	HANDLE	AISI 304
16	HANDLE SLEEVE	PVC

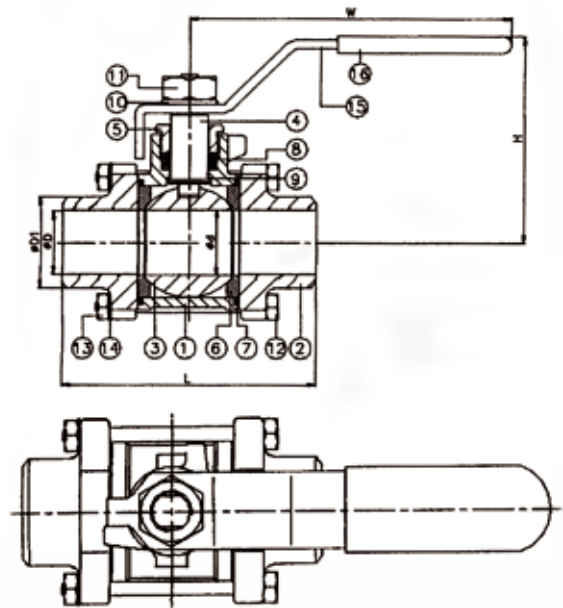

## DIMENSIONS

SIZE	IN	1/4	3/8	1/2	3/4	1	1 1/4	1 1/2	2	2 1/2	3	4
d		11.6	12.7	15	20	25	32	38	50	65	80	100
L		64	64	65	75	85	99	112	129	164	188	224
H		60	60	63	37	83	86	105	114	143	159	184
W		98	98	98	125	146	146	186	186	246	246	285
D		11.6	12.7	15	20.2	25.4	32.2	38.3	51	65	80	100
D1		17	17	15.9	27.3	33.5	41.5	48.6	62	76.3	92	115
Cv		6	7	10	25	35	46	80	110	310	360	820





**SIGHT GLASS SK-B1  
SCREWED END**



**MODEL : SK-B1 SCREWED END**

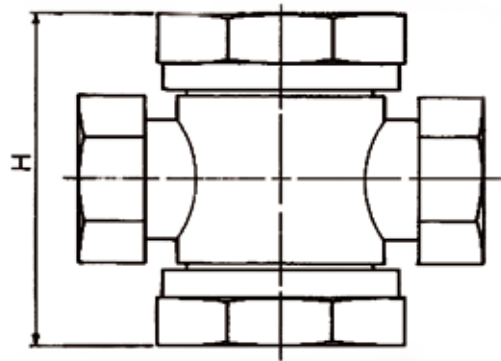
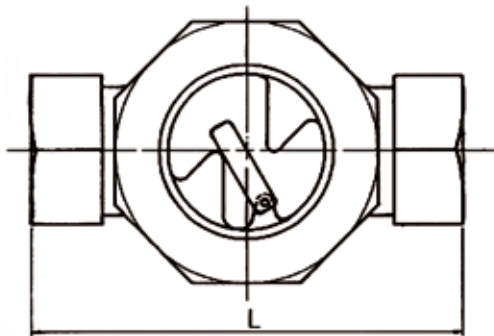

**USAGE SCOPE :**  
**STEAM, GENERAL, LIQUID**

PART NAME	MATERIAL
BODY	CAST IRON
MAIN PART	304

W.P	0.35~7 kg/cm <sup>2</sup>
W.T	220°C

**DIMENSIONS**

NOMINAL	SIZE	1/2B	3/4	1	1 1/4	1 1/2	2
		15A	20	25	32	40	50
L		120	120	138	145	145	145
H		100	100	105	135	135	145



# SIGHT GLASS SK-B2 FLANGED



MODEL : SK-B2 FLANGED JIS10K, ANSI150, PN16

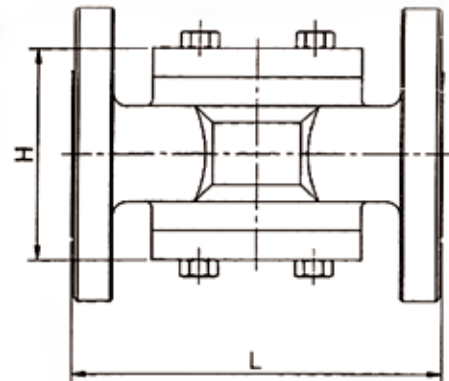
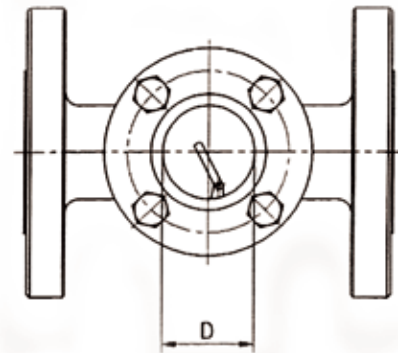

USAGE SCOPE :  
STEAM, GENERAL, LIQUID

W.P	0.35~7 kg/cm <sup>2</sup>
W.T	220°C

PART NAME	MATERIAL	MATERIAL
BODY	S.S.304, S.S.316, WCB	CAST IRON
MAIN PART	S.S.304, S.S.316	S.S.304

## DIMENSIONS

SIZE	IN	1/2	3/4	1	1 1/4	1 1/2	2	2 1/2	3	4	5	6	8
L		130	130	170	200	200	220	270	270	320	380	420	500
		130	130	170	200	200	220	270	270	320	380	420	500
H		71	76	77	115	115	125	155	166	194	224	254	306
		100	100	106	125	125	130	158	171	200	238	264	330
D		40	40	40	50	50	50	85	85	110	130	160	160
		40	40	40	50	50	50	85	85	110	130	160	160



# SIGHT GLASS SK-T6 SCREWED END



MODEL : SK-T6 SCREWED END

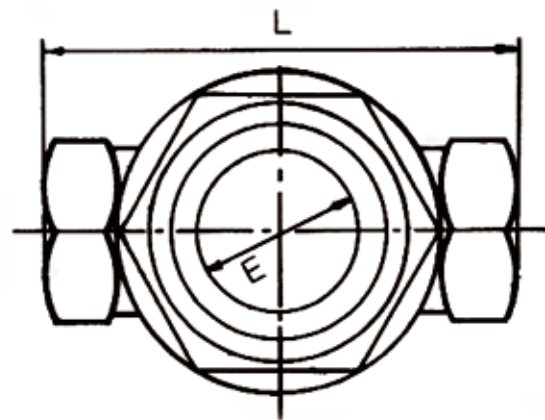

USAGE SCOPE :  
STEAM, GENERAL, LIQUID

PART NAME	MATERIAL
BODY	CAST IRON

W.P	0.35~7 kg/cm <sup>2</sup>
W.T	220°C

## DIMENSIONS

SIZE	IN	1/2	3/4	1	1 1/4	1 1/2	2
L		75	90	90	120	120	140
E		22	30	30	42	42	53



# SIGHT GLASS SK-T8 SCREWED END



## MODEL : SK-T8 SCREWED END

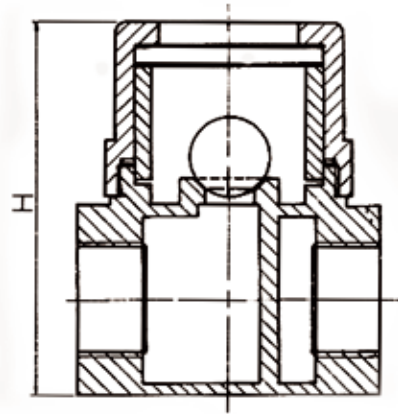

PART NAME	MATERIAL
BODY	CAST IRON
MAIN PART	TEFLON

W.P	0.35~7 kg/cm <sup>2</sup>
W.T	220°C

USAGE SCOPE :  
STEAM, GENERAL, LIQUID

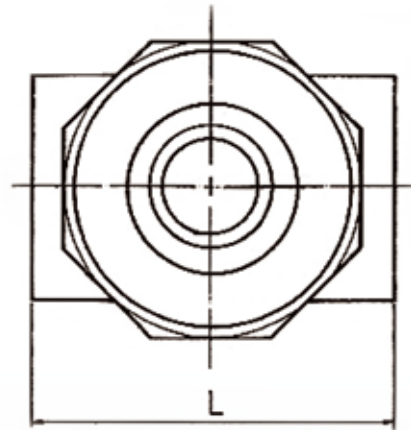

### DIMENSIONS

NOMINAL \ SIZE	1/2B	3/4	1	1 1/4	1 1/2	2
	15A	20	25	32	40	50
L	76	76	80	122	122	126
H	92	92	98	116	116	128



## SIGHT GLASS SK-T9 15~25 SCREWED END

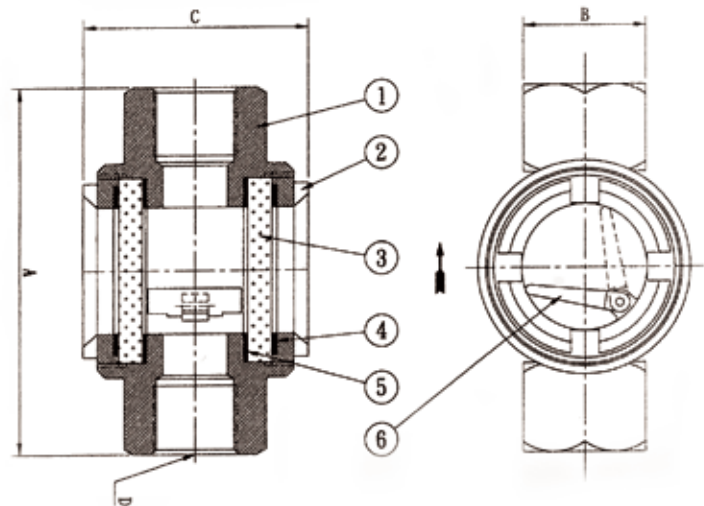

ITEM	PART NAME	MATERIAL
1	BODY	S.S304 S.S316
2	CAP	S.S304 S.S316
3	GLASS	TEMPERED
4	PACKING	PTFE
5	PACKING	PTFE
6	DISC	S.S304 S.S316

**TESE PRESSURE :**  
**BODY 230PSI (WATER)**  
**SEAT 100PSI (AIR)**

### DIMENSIONS

NOMINAL	SIZE	A	B	C	D
		15	108	30	68
20	113	36	68	3/4PT	
25	113	43	68	1"PT	



# SIGHT GLASS SK-T9 32~50 SCREWED END



ITEM	PART NAME	MATERIAL
1	BODY	S.S304 S.S316
2	CAP	S.S304 S.S316
3	GLASS	TEMPERED
4	BOLT	S.S304 S.S316
5	PACKING	PTFE
6	PACKING	PTFE
7	DISC	S.S304 S.S316

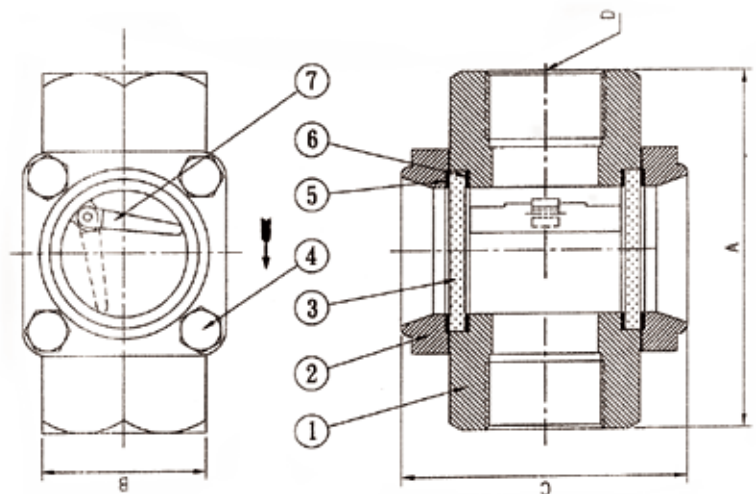

TESE PRESSURE : **BODY 230PSI (WATER)**  
**SEAT 100PSI (AIR)**

### DIMENSIONS

NOMINAL \ SIZE	A	B	C	D
32	125	56	100	1 1/4 PT
40	125	59	102	1 1/2 PT
50	170	74	120	2" PT



# CHECK VALVE



PART NAME	MATERIAL
BODY	304, 316

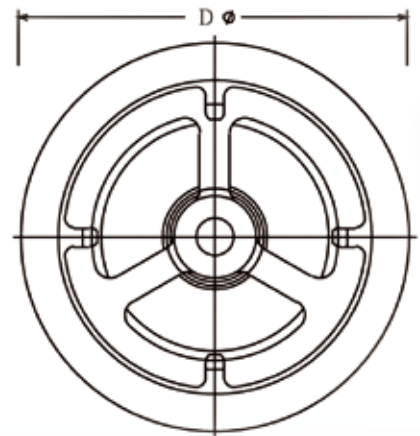
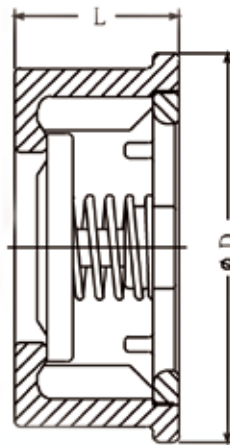

## DIMENSIONS

ω : 螺栓長度

NOMI- SIZE	25A	32A	40A	50A	65A	80A	100A	125A	150A
	1B	1 1/4 B	1 1/2 B	2B	2 1/2 B	3B	4B	5B	6B
D	70	80	86	100	120	130	155	185	215
L	24	34	34	44	49	53	63	90	105
ω	M16x 3"	M16x 3 1/2"	M16x 3 1/2"	M16 x4"	M16 x4"	M16 x4 1/2"	M16 x5"	M20 x6"	M20 x7"



## CHECK VALVE



PART NAME	MATERIAL
BODY	CF8M 304
VALVE	304
SPRING	304
SEAT	PTFE

### DIMENSIONS

SIZE \ IN	2	2 1/2	3	4	5	6	8
<i>L</i>	183	200	210	217	255	280	416
<i>D</i>	155	175	185	210	250	280	330





# Automatic Air Vent Valve



10K/16K 自動釋氣閥(大流量型)Fig:614  
Fig.AAV-10K Fig.AAVH-16K

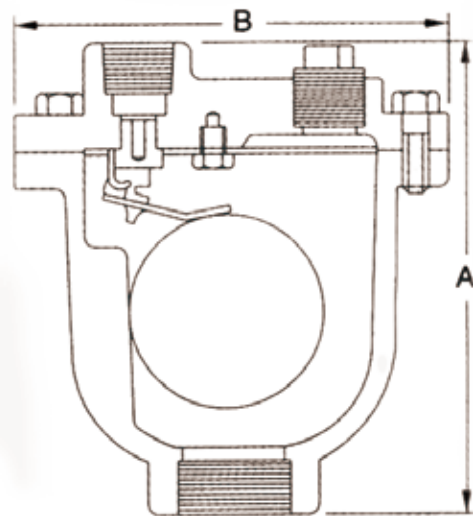

Bolted Cover, Automatic Air Release Type,  
Stainless Steel Trim & Float, Epoxy Coating  
In & Out, Threaded End.

Part 零件	Material 材質	最高使用壓力	AAV (10K)	AAVH (16K)	AAVP (PN 16)	
Body 閥體	Cast Iron/Ductile FC20/FCD45	80°C 以下之靜流水	14.0 kgf/cm <sup>2</sup>	22.0 kgf/cm <sup>2</sup>	20 Bar	
Cover 閥蓋	Cast Iron/Ductile FC20/FCD45	80°C 以下之動脈水	10.0 kgf/cm <sup>2</sup>	16.0 kgf/cm <sup>2</sup>	16 Bar	
Lever Frame 槓桿架	Stainless Steel SUS304	試驗壓力 (水壓)				
Seat 閥座	Stainless Steel SUS304		AAV(10K)	AAVH(16K)	AAVP(PN 16)	
Float 浮球	Stainless Steel SUS304	閥體	20 kgf/cm <sup>2</sup>	32 kgf/cm <sup>2</sup>	24 Bar	
Gasket 墊片	Non-Asbestos/NBR	閥座	15 kgf/cm <sup>2</sup>	24 kgf/cm <sup>2</sup>	18 Bar	
Float Arm 浮桿	Stainless Steel SUS304	尺寸 Dimensions 單位 mm				
Orifice Button 頂塞	Stainless Steel SUS304	標稱口徑	A	B	頂塞孔徑	
Cashion 氣墊	NBR	m/m			排放口	
		Inch				
		15	133	121	1.6	1/2"
		20	133	121	1.6	1/2"
		25	133	121	1.6	1/2"

塗裝訂製：

依CNS-13273之標準，閥體及閥蓋採內外環氧樹脂粉體塗裝，塗膜厚度120 μ ± 25 μ。



## BUTTERFLY VALVE

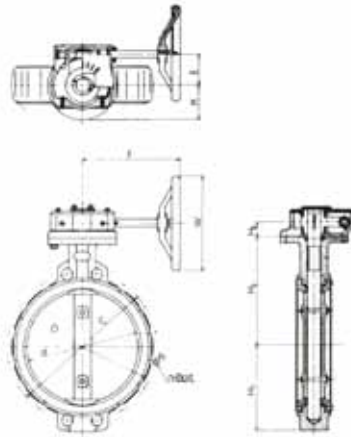

### MAIN PART MATERIALS

PART NAME	MATERIAL
BODY	CAST IRON
DISC	DUCTILE IRON & STAINLESS STEEL
SEAT	ELASTOMER (NBR, EPDM, BUNA-N)
STEM	STAINLESS STEEL
WORM GEAR	DUCTILE IRON
WORM	CARBON STEEL
GEAR BOX	CAST IRON
HANDLE	CAST IRON

W.P.	10 kg/cm <sup>2</sup>
W.T.	80°C~120°C

**FLANGE SPECIFICATION :**  
JIS 5kg f/cm<sup>2</sup>, JIS 10kg f/cm<sup>2</sup> & ANSI 125, 150 Lbs

**USAGE SCOPE :** WATER, OIL, AIR, POWDER, GENERAL LIQUID

(mm)

### DIMENSIONS

SIZE	SYMBOL	d	D	L	d <sup>2</sup>	H <sub>1</sub>	H <sub>2</sub>	H <sub>3</sub>	E	K	F	W	Kg	ANSI 125, 150 Lbs		JIS 10 kgs f/cm <sup>2</sup>	
		C	n-h-Bolt	C	n-h-Bolt												
10"	250	248	324	80	32	204	256	40	70	78	195	173	34.7	361.9	12-26-U7/8	355	12-25-M22
12"	300	291	369	90	32	245	283	40	70	78	195	173	42.1	431.8	12-26-U7/8	400	16-25-M22

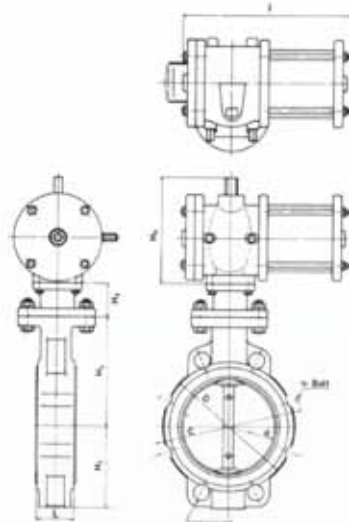

### MAIN PART MATERIALS

PART NAME	MATERIAL
BODY	CAST IRON
DISC	DUCTILE IRON & STAINLESS STEEL
SEAT	ELASTOMER (NBR, EPDM, BUNA-N)
STEM	STAINLESS STEEL
AIR CYLINDER	CAST IRON

W.P.	10 kg/cm <sup>2</sup>
W.T.	80°C~120°C

**FLANGE SPECIFICATION :**  
JIS 5kg f/cm<sup>2</sup>, JIS 10kg f/cm<sup>2</sup> & ANSI 125, 150 Lbs

**USAGE SCOPE :** WATER, OIL, AIR, POWDER, GENERAL LIQUID

UNIT : (mm)

### DIMENSIONS

NOMINAL SIZE		d	L	D	H <sub>1</sub>	H <sub>2</sub>	H <sub>3</sub>	H <sub>4</sub>	I	ANSI 125, 150 Lbs		JIS 10 kgs f/cm <sup>2</sup>	
INCH	MM									C	n-h-BOLT	CK	n-h-BOLT
2	50	54	44	91.5	58	107	57	115	190	120.6	4-20-U5/8	120	4-19-M16
2 1/2	65	68	44	107.5	65	120	57	115	190	139.7	4-20-U5/8	140	4-19-M16
3	80	79	50	123	75	137	57	124	190	152.4	4-20-U5/8	150	8-19-M16
4	100	100	51	152	107	152	57	149	240	190.5	8-20-U5/8	175	8-19-M16
5	125	125	55	185	120	165	57	175	270	215.9	8-23-U3/4	210	8-19-M20
6	150	149	60	215	135	183	57	175	270	241.3	8-23-U3/4	240	8-23-M20
8	200	189	65	259	165	210	67	211	310	298.4	8-23-U3/4	290	12-23-M20
10	250	248	80	324	204	256	67	235	370	361.9	12-26-U7/8	355	12-25-M22



# BUTTERFLY VALVE



## 50A - 80A

## 100A - 300A

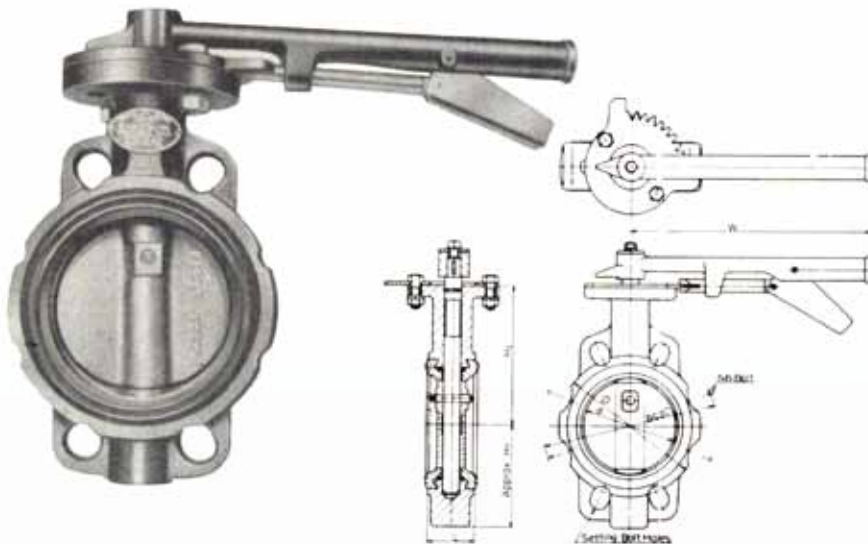
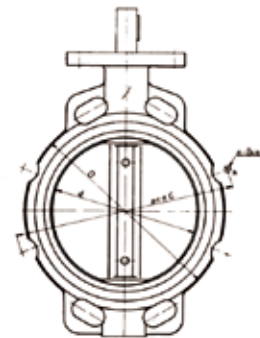
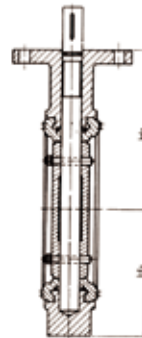
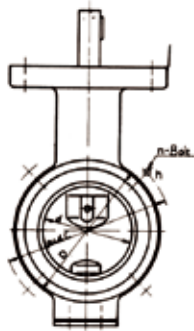
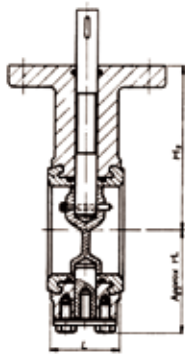
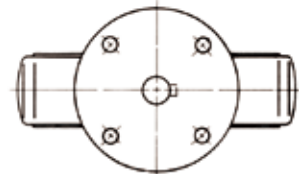

### MAIN PART MATERIALS

PART NAME	MATERIAL
BODY	CAST IRON
DISC	DUCTILE IRON & STAINLESS STEEL
SEAT	ELASTOMER (NBR, EPDM, BUNA-N)
STEM	STAINLESS STEEL
HANDLE	DUCTILE IRON

W.P.	10 kg/cm <sup>2</sup>
W.T.	80°C~120°C

### FLANGE SPECIFICATION :

JIS 5kg f/cm<sup>2</sup>, JIS 10kg f/cm<sup>2</sup> & ANSI 125, 150 Lbs

**USAGE SCOPE :** WATER, OIL, AIR, POWDER, GENERAL LIQUID

### DIMENSIONS

(mm)

SIZE	SYMBOL	d	L	W	D	H1	H2	d2	Kg	ANSI 125, 150 Lbs		JIS 10 kgs f/cm <sup>2</sup>	
										C	n-h-BOLT	C	n-h-BOLT
2"	50	54	44	260	91.5	58	107	14	4.3	120.6	4-20-U5/8	120	4-19-M16
2 1/2"	65	68	44	260	107.5	65	120	14	4.5	139.7	4-20-U5/8	140	4-19-M16
3"	80	79	50	260	123	75	137	16	5.3	152.4	4-20-U5/8	150	8-19-M16
4"	100	100	51	260	152	107	152	16	6.8	190.5	8-20-U5/8	175	8-19-M16
5"	125	125	55	305	185	120	165	19	11	215.9	8-23-U5/8	210	8-23-M20
6"	150	149	60	305	215	135	183	19	12.8	241.3	8-23-U5/8	240	8-23-M20
8"	200	189	65	352	259	165	210	25	18.5	298.4	8-23-U5/8	290	12-23-M20